

SUPRA SERIES



SAME HIGH STANDARDS. ALL NEW SUPRA POWERS.





MEET THE POWERFUL AND STYLISH SEQUEL TO THE DIESEL TRUCK REFRIGERATION UNITS THAT HAVE SET THE INDUSTRY STANDARD FOR DECADES

For more than 20 years, Carrier Transicold's Supra® truck refrigeration units have delivered performance and reliability that's been nothing short of heroic. Now with the Supra Series, we've taken everything you love about the previous generation of Supra units and built upon it. We have incorporated advanced technologies that increase performance, lower maintenance and operating costs, and provide better fuel efficiency, while continuing to improve on the quality and reliability that has been the foundation of the Supra diesel truck series — and it all comes in a sleek design that looks great on the road.

It's the latest in a long line of reliable truck refrigeration units from Carrier Transicold. You trust the name — now see for yourself how we've taken one of the industry's most proven diesel truck refrigeration platforms and made it leaner, smarter and filled with powerful advantages for fleets of all sizes.



SUPRA
SERIES

AN UNSTOPPABLE FORCE

With 20 years of proven performance on the road, the Supra name is synonymous with reliability. The Supra Series extends that legacy with a design that will keep your units on the road longer and help you get the most out of your investment.

- Fewer mechanical components and 42% fewer parts overall than prior models eliminate many maintenance items that can cause extended downtime and repair costs.
- Next-generation APX™ control system combines remarkable control intelligence, temperature control and system reliability with amazingly simple operation.
- Enhanced power-management system communicates with a smarter engine and intelligent refrigeration controls via the integrated APX control system. The result is a high-efficiency platform that generates higher capacity and performance using significantly less power than prior models.
- Innovative engineering combined with a straightforward, practical design means less fuel consumption, reduced engine run hours and lower maintenance costs than prior models.
- Optional telematics compatibility provides greater visibility, real-time temperature monitoring and robust data management such as automatic “proof of temperature” compliance reports to maintain food safety standards.





Carrier

OPERATION: SUPERIOR PERFORMANCE

1 **Brazed Plate Heat Exchanger (BPHX).**

The ultra-compact brazed plate heat exchanger offers up to five times greater efficiency than large, traditional "tube and shell" designs. The BPHX increases unit efficiency and reduces engine power requirements and fuel use.

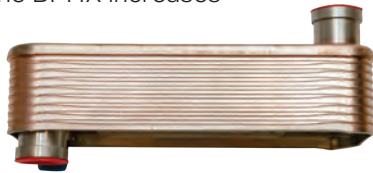

2 **Suction Modulation Valve (SMV).**

The valve controls the flow of refrigerant gas to provide better temperature control and power regulation. Always operating the compressor at or near its functional design "sweet spot" means it is always running at peak efficiency, reducing engine power, fuel use and emissions.



3 **Maintenance-Free Electric Condenser Fan.**

Designed to reduce power requirements and noise, the fan(s) also provide more airflow and ensure peak performance in the hottest environments.



4 **Serpentine Belt.**

A single long-life serpentine belt with an automatic tensioner replaces the previous system of four V belts, extending the lifespan and eliminating idler pulleys and bearing noise.



5 **Electronic Speed Control Engine.**

A smarter engine that eliminates traditional solenoids and provides two-way communication, allowing precise speed control at multiple operating points to deliver high performance with minimal fuel consumption.



Front View

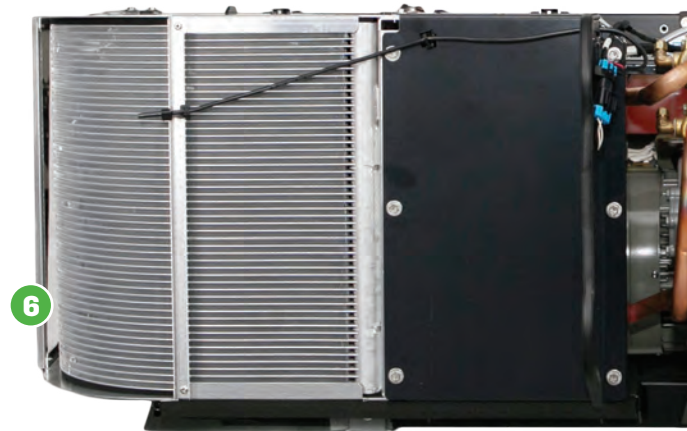

6

Top View

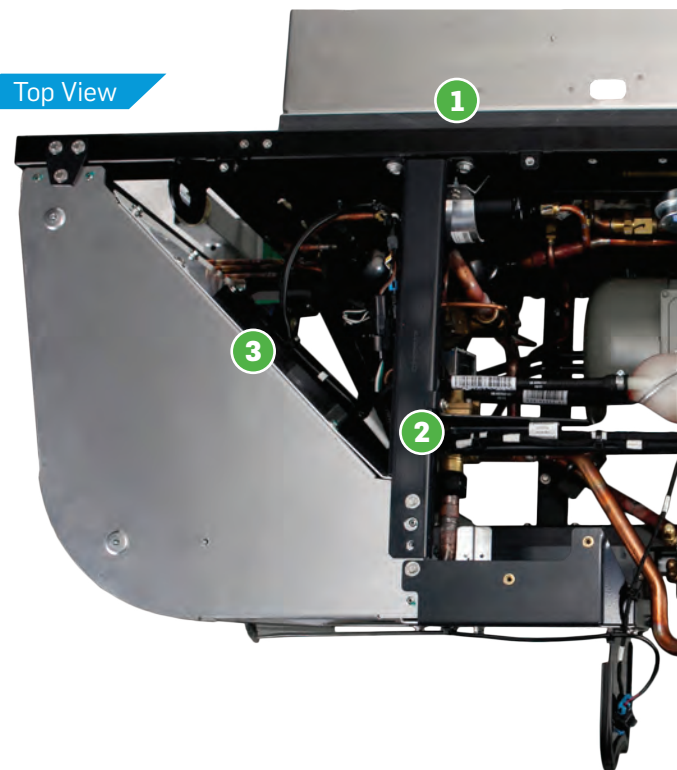

1

3

2

CE — BUILT RIGHT IN

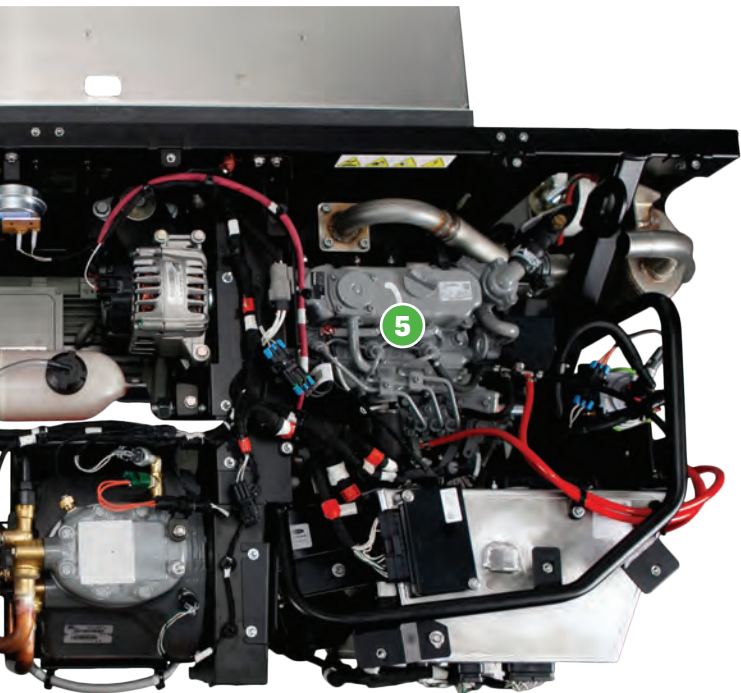
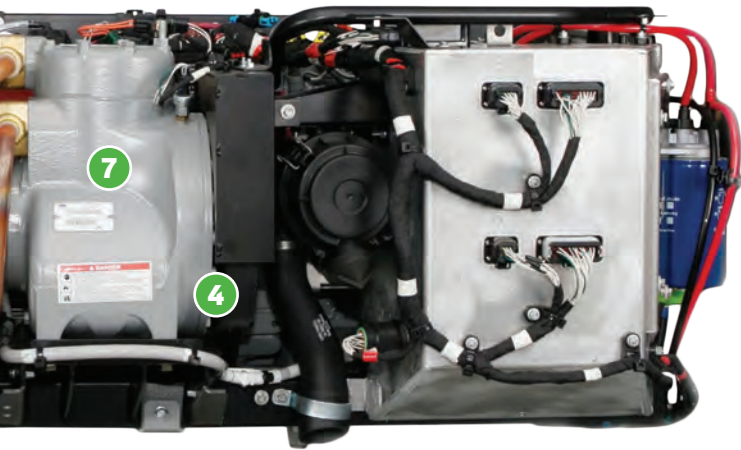

6 **Microchannel Heat Exchanger.**

This technology provides a lighter, damage-resistant, ultra-high efficiency coil that reduces the amount of refrigerant used, increases performance, saves fuel and keeps the system running in the harshest conditions.



7 **Compressor.**

The high-efficiency compressor delivers high capacity and fast pulldown while running at lower speeds, resulting in reduced horsepower, lower fuel use and extended unit life.



8 **Cab Command Controller.**

Featuring a bright, backlit LCD display, the controller provides an at-a-glance presentation of operating information, including setpoint, compartment temperature, mode of operation and alarm notification. Its compact design conforms to the universal DIN specification, enabling simple and clean installation within the truck cab's dash.



9 **APX Control System.**

Uniting a variety of advanced electronics and efficient components to continually balance optimum fuel efficiency and performance, the APX control system ensures high-efficiency operation and precise temperature control.

10 **Composite Panels.**

A sleek new look is combined with the latest composite materials that repel dirt and resist damage.



IMPROVING ON A PROVEN PERFORMER

Our customers asked, and we delivered in a big way. The Supra Series combines a simple, practical design with truly innovative engineering to provide a diesel truck refrigeration system that is now quieter, lighter and even more dependable than prior models.*

Exclusive to Carrier Transicold, the Supra architecture groups the engine and compressor on one side of the unit. This high-efficiency design delivers significant benefits including:

- Higher-efficiency design for a higher-performing unit with less power that allows the unit to operate at lower speeds.
- Lower-noise performance — up to 3 db(A) quieter on the base truck unit. Additional sound reduction available with the optional Stealth kit.
- 50% reduction in refrigerant charge from the high-efficiency microchannel condenser unit providing better performance and a reduction in weight.
- Up to 300 pounds lighter (certain models) due to fewer components and a more streamlined design.
- Simplified drive system — eliminated three belts and belt idlers and replaced them with a single serpentine belt with an automatic tensioner, extending the lifespan of the drive system.

*Performance data compared to the Carrier Transicold models they replace and dependent on a range of operational settings, environmental conditions, and model type.





SUPRA SERIES

SUPRA S6

SUPRA S7

ENGINE CAPACITY	35°F (2°C)	16,000 BTU/hr 4,689 Watts	19,000 BTU/hr 5,568 Watts
	0°F (-18°C)	10,000 BTU/hr 2,931 Watts	12,000 BTU/hr 3,517 Watts
	20°F (-29°C)	5,000 BTU/hr 1,465 Watts	6,000 BTU/hr 1,758 Watts

STANDBY CAPACITY	35°F (2°C)	16,000 BTU/hr 4,689 Watts	19,000 BTU/hr 5,568 Watts
	0°F (-18°C)	10,000 BTU/hr 2,931 Watts	11,500 BTU/hr 3,370 Watts
	20°F (-29°C)	5,000 BTU/hr 1,465 Watts	6,000 BTU/hr 1,758 Watts

WEIGHT	Without standby	844 lb (383 kg)	860 lb (390 kg)
	With electric standby	950 lb (431 kg)	955 lb (434 kg)

Ambient at 100°F (38°C)



Application information above dependent on setpoint and use. Unit selection may vary. Visit your Carrier Transicold dealer for a review of your requirements.

TAKE CONTROL OF THE ELEMENTS

When it comes to refrigerated transport, control is key. And the Supra Series was designed to deliver more of it than ever before. Our engineers have enhanced the platform with new control features and components to give it higher performance, faster pulldown and precise temperature control. For you, it translates into more control of your operations and lower operating costs.

- The APX™ control system — as seen on the Carrier Transicold X4™ and Vector™ platforms — provides the ideal balance of temperature control, fuel management and remarkable control intelligence to maintain an ideal environment inside the truck.
- An electronic suction modulation valve and a brazed plate heat exchanger give the unit a more efficient energy profile and improved pulldown.
- An optional electric standby system cuts fuel consumption, engine noise and emissions while boosting operational savings.
- A multi-speed control engine continually communicates with the APX control module to optimize performance and eliminate wasted power.
- A variable speed condenser fan reduces power requirements and noise, while providing more airflow.
- A microchannel condenser reduces refrigerant charge, provides better performance and is lighter weight.



SUPRA S8

22,000 BTU/hr 6,448 Watts
14,000 BTU/hr 4,103 Watts
8,500 BTU/hr 2,491 Watts

20,000 BTU/hr 5,861 Watts
13,000 BTU/hr 3,810 Watts
7,000 BTU/hr 2,051 Watts

865 lb (393 kg)
960 lb (436 kg)

SUPRA S9

24,000 BTU/hr 7,034 Watts
18,500 BTU/hr 5,422 Watts
11,500 BTU/hr 3,370 Watts

23,500 BTU/hr 6,887 Watts
17,500 BTU/hr 5,129 Watts
10,000 BTU/hr 2,931 Watts

908 lb (413 kg)
1,015 lb (460 kg)

SUPRA S10

37,000 BTU/hr 10,850 Watts
23,000 BTU/hr 6,740 Watts
15,000 BTU/hr 4,400 Watts

27,000 BTU/hr 7,915 Watts
21,000 BTU/hr 6,155 Watts
14,000 BTU/hr 4,105 Watts

1,025 lb (466 kg)
1,102 lb (501 kg)

DIUM

LARGE

28'



MODERNIZE YOUR OPERATIONS WITH CARRIER'S CUSTOMIZABLE eSOLUTIONS™ PLATFORM

In a world that's constantly changing and always on the go, operators and drivers need the ability to make data-driven decisions in real time. Carrier's eSolutions platform with TRU IQ allows you to do exactly that.

Regardless of the size of your fleet or business, the benefits of the eSolutions platform can be as vast as you need them to be. Designed specifically for Carrier Transcold refrigeration units, the eSolutions platform offers a centralized, web-based access point for monitoring your units on the road and managing them remotely.

You can access data from anywhere, perform software updates, generate compliance reports and receive notifications regarding door openings, vehicle locations and cargo temperatures. With a configurable web-based dashboard, the eSolutions platform gives you the intelligence and flexibility to keep your operations running smoothly.





MANUFACTURED FOR QUALITY

Every Supra diesel truck is assembled in the United States by a specialized workforce at Carrier Transicold's Athens, Georgia, flagship facility. Our ISO-certified plant uses a variety of advanced manufacturing technologies and processes that are tightly controlled and designed for maximum productivity. Carrier Transicold's manufacturing philosophy is centered on safety, sustainability and

state-of-the-art technology, with the ultimate goal of delivering the highest-quality product at the best price.

- ISO 9001 and ISO 14001 Process Certification
- OSHA Voluntary Protection Program Star Status
- Automated Processes and Lean Manufacturing



WHEREVER THE ROAD TAKES YOU

At Carrier Transicold, we know that dependability means more than just outlasting the competition. It's also about being there for the unexpected and having the support of your local Carrier dealer.

Our dealers are expertly trained and equipped to provide the professional personnel and superior technical support you depend on to maintain and service your truck refrigeration units.

- With 180 locations across North America and 24/7 service access, help is never out of reach.
- Our dealer technicians undergo hours of rigorous factory training so they know the products inside and out, and have the ability to diagnose issues and find solutions to get your units back on the road as soon as possible.
- Our dealers make sure a comprehensive stock of critical parts is available to service our products.
- By ensuring that expert service and repairs are available right around the corner, we make certain you can trust Carrier Transicold's Dealer Network to be there to handle all your maintenance and service needs.



THE POWER OF SUPPORT

You can rest easy knowing that Carrier Transicold Performance Parts and aftermarket support programs will keep your equipment running at peak performance and efficiency for years to come.



Carrier Transicold's BluEdge Service Offerings



IT'S NEVER BEEN EASIER TO GIVE YOUR FLEET AN EDGE

Now you have more choice when it comes to protecting your investments – and your bottom line. Whether you want to maintain equipment on your own with as-needed service or put solutions in place for proactive maintenance and equipment monitoring, we have a plan that can help you:

Choose from three tiers of service designed to provide optimal value for your business.

- **Core** – Supplements the original equipment factory warranty with extended coverages for major components, the entire system or a more customized approach based on customer preferences.
- **Enhance** – Provides scheduled preventive maintenance inspections with proactive replacement of parts such as belts, starters and alternators.
- **Elite** – Protects through extended warranties plus preventive maintenance services resulting in the ultimate worry-free program for customers who demand the highest level of service, uptime and fiscal certainty.

SUPRA SERIES

Supra-powered innovation

Turn to the next generation in the industry's most trusted diesel truck refrigeration unit.

With new technology, first-in-class architecture, reduced maintenance and lower operating costs, there's no better time to upgrade to the Supra Series. Talk to your local Carrier dealer today — then count on us to be by your side to help you deliver on all your business needs.

Supra Series by the numbers*:



- Weighs up to **300 pounds less** than previous models
- Contains **42%** fewer parts
- Consumes up to **37%** less fuel
- 4 tons of **CO₂** per unit savings per year
- Extended **2,000** hour service interval
- Requires **50%** less refrigerant
- Operates **18%** slower in high speed
- Provides up to **50%** higher BTU-per-gallon efficiency
- **24/7** service access, through your local Carrier Transcold dealer

*Performance data compared to the Carrier Transcold models they replace are dependent on a range of operational settings, environmental conditions, and model type. Specifications are subject to change without notice. Form 62-12133 Rev. B.

North America
Carrier Transcold
700 Olympic Drive
Athens, GA 30601 USA

Central America and Mexico
Carrier Transcold
Ejercito Nacional 253-A Piso 5
Colonia Anahuac
11320 Mexico D.F.

